

CONSTRUCTION SITE MONITORING SYSTEM

PREFABRICATED HOUSES
AND DRYWALL CONSTRUCTION

 made
 in
 Germany





DESCRIPTION

CONSTRUCTION SITE MONITORING SYSTEM

A construction site monitoring system enables continuous monitoring and early detection of potential risks to prevent delays and elemental damages.

Through its implementation and real-time information, construction management, trades, clients, and planners can collaborate even more closely and better coordinate the planned workflow.

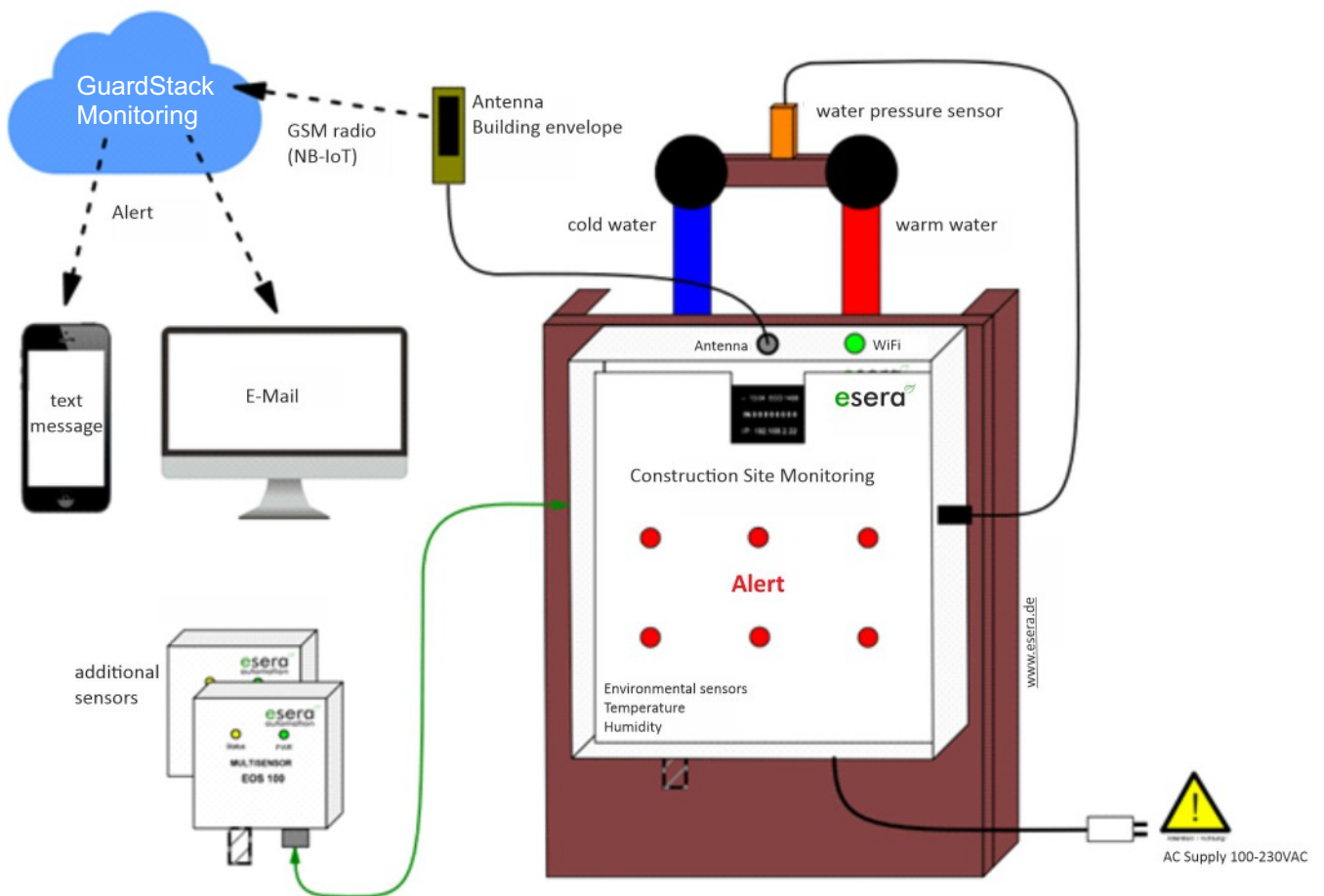



MOISTURE / WOOD MOISTURE

MOISTURE CONTROL

Wood moisture is generated through the absorption of water from the environment or direct contact with water. This can cause elemental damage, leading to significant costs.

Our construction site monitoring system for prefabricated houses and drywall construction offers a monitoring solution for the entire building.

The central components of this system are:

- environmental measurement technology for water and moisture
- state-of-the-art radio technology
- smart power supply
- cloud service with alerting

By analyzing water pressure, potential issues such as leaks, pipe bursts or other water problems can be detected early.

The environmental sensor measures the humidity in the room, also in real-time, to detect potential damage from high humidity, for example during floor drying, early on.

State-of-the-art radio technology connects to the BMS Cloud.

In case of issues, you or the site manager will be alerted.

ESERA SOLUTION - AS SIMPLE AS THAT

Continuously monitor key parameters and receive immediate alerts in case of issues.

With the ESERA BMS, you get tailored monitoring for your valuable building.

Our advanced monitoring technology provides real-time monitoring and customizable alarm notifications. This allows you to proactively intervene before major damages occur.



Patented Plug and Play Hardware

ESERA Environment Measurement System



Temperature



Air humidity, rel.



VOC, Air Quality



Co2, Carbon dioxide



Smoke, fire



Particulate matter

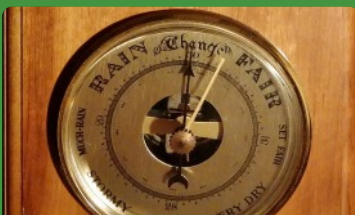

Barometric air pressure, hPa



Differential pressure sensor



Ozone, O3



Nitrogen dioxide, No2



Your individual sensor



Water, moisture

Contact details

ESERA GmbH
Adelindastraße 20
87600 Kaufbeuren
GERMANY

Phone +49 8341 99980-0
E-Mail us. info@esera.de
www.esera.de



<https://lnk.esera.de/le89aeyv>

In collaboration with
<https://guardstack.com>

**guard
stack**

Trademarks

All mentioned designations, logos, names and trademarks (including those which are not explicitly marked) are trademarks, registered trademarks or other copyright or trademarks or titles or legally protected designations of their respective owners and are hereby expressly recognized as such by us. The mention of these designations, logos, names and trademarks is made for identification purposes only and does not represent a claim of any kind on the part of ESERA GmbH on these designations, logos, names and trademarks. Moreover, from their appearance on ESERA GmbH webpages it cannot be concluded that designations, logos, names and trademarks are free of commercial property rights. ESERA and Auto-E-Connect are registered trademarks of ESERA GmbH. Auto-E-Connect is registered by ESERA GmbH as a German and European Patent.